

Ball Valves Threaded

ANSI

Bronze

FB & RB, Split Body, 300#



Fig. 1608-B61
Fig. 1608 RB-B61

**Reduced Bore &
Full Bore**

Description

Bronze ball valve, female threaded ends, 2 piece (split) body, floating ball, full and reduced bore (RB), Screwed Bonnet (SB), PTFE seated, pressure class 300# (Class 150# included).

Full Bore : GVC 1608-B61
Reduced Bore : GVC 1608 RB-B61

Technical Features

Design	Generally in accordance with ISO 17292 Body, bonnet castings from a Marine Class Society Approved Foundry on request
Marking	In accordance with ISO 17292, ISO 5209
Testing	In accordance with ISO 17292, ISO 5208, API 598
Face to Face	Manufacturer's standard, see below dimensions table
Thread Dimensions	NPT female thread in accordance with ASME B1.20.1
Pressure Rating	MSS SP-80-Class 300# *
Temperature Range	-29°C to +175°C Note: PTFE seated valves are limited to max. +175°C**
Options	- In other bronze materials - BSP female threaded (Suffix BSP) - Other seat, ball and stem materials

Pressure and Temperature Range [Barg/°C]

DN	Press Class	Mat.	Pressure / Temperature Rating to MSS SP-80 * [Barg / °C]											
			-29/+66	+93	+121	+149	+175**	+177	+204	+232	+260	+288	°C	
½"-3"	300#	B61	41.37	38.61	36.20	33.78	31.22							Barg

* Above P-T table is extracted from MSS SP-80 material ASTM B61 class 300#

** PTFE seated valves are limited to maximum +175°C

Materials

Parts Description	Figure 1608-B61, 1608 RB-B61
Body	Cast Bronze ASTM B61
Cap	Cast Bronze ASTM B61
Ball	Brass ASTM B124-C37700
Stem	Brass ASTM B124-C37700
Seat Rings	PTFE
Hand Lever	Stainless Steel ASTM A240-304

Dimensions [mm]

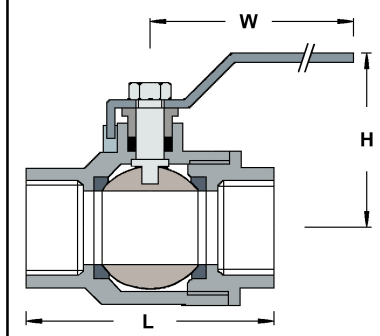

DN	Figure 1608-B61				Figure 1608 RB-B61			
	L	H	W	Weight [Kg]	L	H	W	Weight [Kg]
1/2"	60	45	90.0	0.4 Kg	60	45	90	0.3 Kg
3/4"	75	55	105.0	0.7 Kg	70	45	90	0.6 Kg
1"	85	60	121.5	1.2 Kg	85	51	105	1.0 Kg
1 1/2"	102	60	105.0	2.6 Kg	102	60	105	2.3 Kg
2"	--	--	--	--	118	105	290	3.8 Kg
3"	--	--	--	--	180	112	290	11.6 Kg

Ball Valves Threaded

ANSI

Bronze

FB, 3-Piece Body, 150#

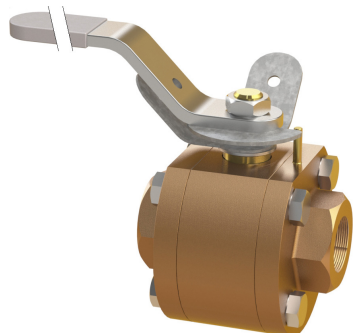

Fig. 7480-B62

Description

Bronze ball valve, female threaded ends, 3 piece body with full lug type center piece, floating ball, full bore (FB), blow-out proof stem, anti-static device, Fire Safe design, PTFE seated, pressure class 150#.

Technical Features

Design	Generally in accordance with BS 5351 Body, bonnet castings from a Marine Class Society Approved Foundry on request
Marking	In accordance with BS 5418
Testing	In acc. with BS 5146 Part 1, API 598, Fire Safe tested and certified to API 6FA
Face to Face	Manufacturer's standard, see below dimensions table
Thread Dimensions	NPT female thread in accordance with ASME B1.20.1
Pressure Rating	MSS SP-80-Class 150# *
Temperature Range	-29°C to +175°C Note: PTFE seated valves are limited to max. +175°C **
Options	<ul style="list-style-type: none"> - In other bronze materials - BSP female threaded (Suffix BSP) - Other seat, ball and stem materials - In pressure class 300# (Suffix 300#)

Pressure and Temperature Range [Barg/°C]

DN	Press Class	Pressure / Temperature Rating to MSS SP-80* [Barg / °C]										
		-29/+66	+93	+121	+149	+175**	+177	+204	+232	+260	+288	°C
3/8"-2"	150#	20.68	18.62	16.55	14.48	12.55						Barg

* Above P-T table is extracted from MSS SP-80 material B62 class 150#

** PTFE seated valves are limited to maximum +175°C

Materials

Parts Description	Figure 7480-B62
Body	Cast bronze ASTM B62
Caps	Cast bronze ASTM B62
Ball	Brass ASTM B124-C37700
Stem	Brass ASTM B124-C37700
Seat Rings, Thrust Washer	PTFE
Gaskets, Packing	Graphite
Cap bolting	Stainless Steel
External nuts	Stainless Steel
Stopper Pin	Brass ASTM B124-C37700
Stopper Plate, Locking Device, Belleville Washers	Steel Galvanized
Hand Lever	Steel + Vinyl

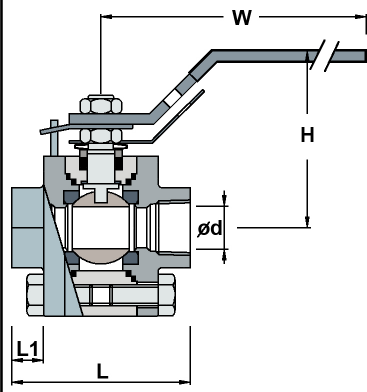

Dimensions [mm]

DN	ød	L	L1	H (Appr.)	W
3/8"	10	64	12.0	64	160
1/2"	15	70	13.5	72	160
3/4"	20	85	14.0	84	180
1"	25	100	17.5	94	180
1 1/4"	32	110	17.5	94	180
1 1/2"	38	120	18.5	100	230
2"	50	155	19.0	115	250

Ball Valves

Flanged

Bronze

Red. Bore, Split Body, 150#



Fig. 7235 RB-B62

Reduced Bore

> DN200 (Trunion mounted Ball)

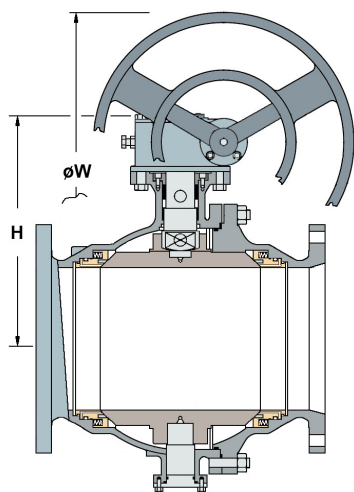

≤ DN200 (Floating Ball)

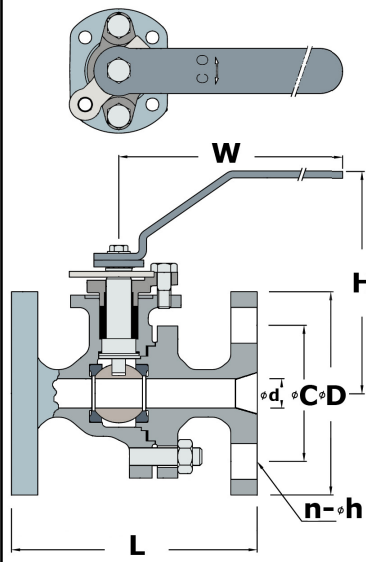

Description

Bronze ball valve, flanged ends (Flat Faced), 2 piece body, (<DN250) floating ball, (≥DN250) trunion mounted ball, reduced bore (RB), PTFE seated, anti-static device, blow-out proof stem, gland packing, ISO 5211 mounting table, pressure class 150#.

Technical Features

Design	Generally in accordance with API 6D, ISO 14313, ASME B16.24 Body, bonnet castings from a Marine Class Society Approved Foundry on request
Marking	In accordance with API 6D, ISO 14313
Testing	In accordance with API 6D, API 598
Face to Face	In accordance with ASME B16.10:2000 Table 1 Column 18
Flange Dimensions	In accordance with ASME B16.5-Class 150# (Flat Faced)
Pressure Rating	In accordance with ASME B16.24-Class 150# *
Temperature Range	-29°C to +175°C Note: PTFE seated valves are limited to max. +175°C **
Options	<ul style="list-style-type: none"> - In ASTM B61 bronze (Suffix B61) - In other bronze materials - With other flanged connections DIN, JIS etc. - With other seat, ball and stem materials - With Marine Class Inspection Certificate (EN10204-3.2) by ABS, BV, DNV, LRS and other (Marine Class) Societies

Pressure and Temperature Range [Barg/°C]

DN	Press Class	Mat.	Pressure / Temperature Rating to ASME B16.24* [Barg / °C]														
			29/66	100	125	150	175**	200	208	225	232	250	275	289	°C		
½"-24"	150#	B62	15.5	14.3	13.4	12.4	11.4										Barg
½"-24"	150#	B61	15.5	14.6	14.1	13.4	12.4										Barg

* Above P-T table is extracted from ASME B16.24 materials ASTM B62 and B61, class 150#

** PTFE seated valves are limited to maximum +175°C

Materials

Parts Description	Figure 7235 RB-B62	Figure 7235 RB-B61
Body, Cap, Ball (> DN100)	Cast Bronze ASTM B62	Cast Bronze ASTM B61
Ball (≤ DN100), Stem	Brass ASTM B124-C337700	Brass ASTM B124-C337700
Seat	PTFE	PTFE
Seat Retainer (> DN200)	Cast Bronze ASTM B62	Cast Bronze ASTM B61

Dimensions [mm]

DN	ød	øD	øC	n x øh	L	H	W	
1/2"	DN15	13	90	60.3	4-15.9	108	99	125
3/4"	DN20	13	100	69.8	4-15.9	117	103	125
1"	DN25	19	110	79.4	4-15.9	127	114	155
1 1/2"	DN40	25	125	98.4	4-15.9	165	139	230
2"	DN50	38	150	120.7	4-19.1	178	149	230
2 1/2"	DN65	51	180	139.7	4-19.1	190	155	350
3"	DN80	51	190	152.4	4-19.1	203	170	350
4"	DN100	76	190	190.5	8-19.1	229	190	450
5" *	DN125	102	255	215.9	8-22.2	356	300	ø 400
6" *	DN150	102	280	241.3	8-22.2	394	316	ø 400
8" *	DN200	152	345	298.5	8-22.2	457	336	ø 400
10" *	DN250	203	405	362.0	12-25.4	533	396	ø 500
12" *	DN300	254	485	431.8	12-25.4	610	396	ø 500
14" *	DN350	305	535	476.3	12-28.6	686	417	ø 500
16" *	DN400	337	595	539.8	16-28.6	762	417	ø 500
18" *	DN450	387	635	577.9	16-31.8	864	458	ø 500
20" *	DN500	438	700	635.0	20-31.8	914	526	ø 710
24" *	DN600	489	815	749.3	20-34.9	1067	565	ø 710

* = With Gear Operator

Ball Valves Flanged

Bronze

Red. Bore, Split Body, 300#

ANSI

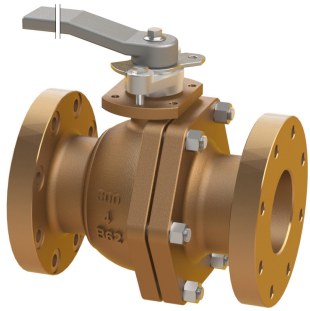
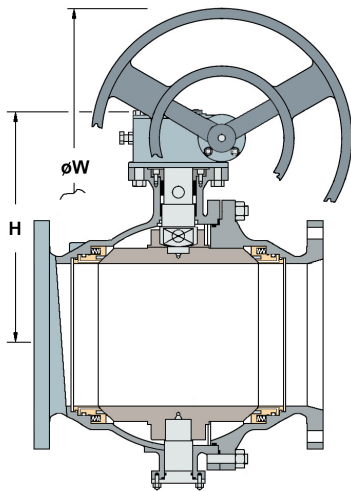

Fig. 7236 RB-B62

Reduced Bore

> DN200 (Trunion mounted Ball)



≤ DN200 (Floating Ball)

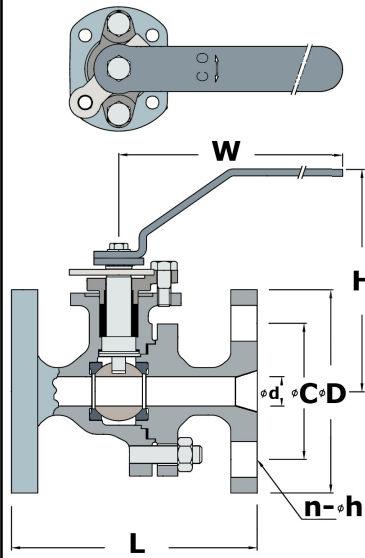

Description

Bronze ball valve, flanged ends (Flat Faced), 2 piece body, (<DN250) floating ball, (≥DN250) trunion mounted ball, reduced bore (RB), PTFE seated, anti-static device, blow-out proof stem, gland packing, ISO 5211 mounting table, pressure class 300#.

Technical Features

Design	Generally in accordance with API 6D, ISO 14313, ASME B16.24 Body, bonnet castings from a Marine Class Society Approved Foundry on request
Marking	In accordance with API 6D, ISO 14313
Testing	In accordance with API 6D, API 598
Face to Face	In accordance with ASME B16.10:2000 Table 2 Column 7
Flange Dimensions	In accordance with ASME B16.5-Class 300# (Flat Faced)
Pressure Rating	In accordance with ASME B16.24-Class 300# *
Temperature Range	-29°C to +175°C Note: PTFE seated valves are limited to max. +175°C **
Options	<ul style="list-style-type: none"> - In ASTM B61 bronze (Suffix B61) - In other bronze materials - With other flanged connections DIN, JIS etc. - With other seat, ball and stem materials - With Marine Class Inspection Certificate (EN10204-3.2) by ABS, BV, DNV, LRS and other (Marine Class) Societies

Pressure and Temperature Range [Barg/°C]

DN	Press Class	Mat.	Pressure / Temperature Rating to ASME B16.24* [Barg / °C]													
			29/66	100	125	150	175**	200	208	225	232	250	275	289	°C	
1/2"-24"	300#	B62	34.5	31.4	29.1	26.8	24.3									Barg
1/2"-24"	300#	B61	34.5	32.4	30.9	29.3	27.6									Barg

* Above P-T table is extracted from ASME B16.24 materials ASTM B62 and B61, class 300#
** PTFE seated valves are limited to maximum +175°C

Materials

Parts Description	Figure 7236 RB-B62	Figure 7236 RB-B61
Body, Cap, Ball (> DN100)	Cast Bronze ASTM B62	Cast Bronze ASTM B61
Ball (≤ DN100), Stem	Brass ASTM B124-C337700	Brass ASTM B124-C337700
Seat	PTFE	PTFE
Seat Retainer (> DN200)	Cast Bronze ASTM B62	Cast Bronze ASTM B61

Dimensions [mm]

DN	ød	øD	øC	n x øh	L	H	W	
1/2"	DN15	13	95	66.7	4-15.9	140	99	125
3/4"	DN20	13	117	82.5	4-19.1	152	103	125
1"	DN25	19	123	88.9	4-19.1	165	114	155
1 1/2"	DN40	25	155	114.0	4-22.2	190	139	230
2"	DN50	38	165	127.0	8-19.1	216	149	230
2 1/2"	DN65	51	190	149.2	8-22.2	241	155	350
3"	DN80	51	210	168.3	8-22.2	282	170	350
4"	DN100	76	255	200.0	8-22.2	305	190	450
5" *	DN125	102	280	234.9	8-22.2	381	300	ø 400
6" *	DN150	102	320	269.9	12-22.2	403	316	ø 400
8" *	DN200	152	380	330.2	12-25.4	502	336	ø 400
10" *	DN250	203	445	387.4	16-28.6	568	396	ø 500
12" *	DN300	254	520	450.8	16-31.8	648	396	ø 500
14" *	DN350	305	585	514.4	20-31.8	762	417	ø 500
16" *	DN400	337	650	571.5	20-34.9	838	417	ø 500
18" *	DN450	387	710	628.6	24-34.9	914	492	ø 710
20" *	DN500	438	775	685.8	24-34.9	991	530	ø 710
24" *	DN600	489	915	812.8	24-41.2	1143	582	ø 800

* = With Gear Operator

Ball Valves Flanged Bronze

ANSI

Full Bore, Split Body, 150#



Fig. 7235-B62

Full Bore

> DN200 (Trunion mounted Ball)

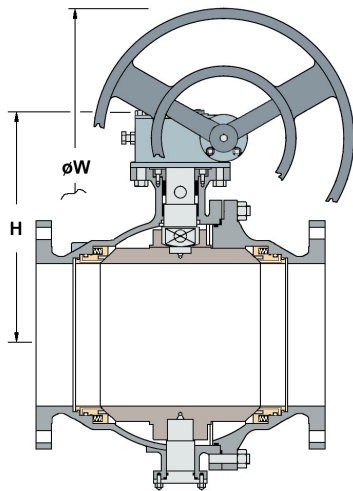

≤ DN200 (Floating Ball)

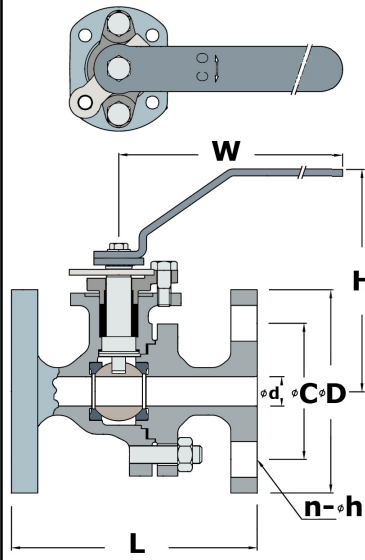

Description

Bronze ball valve, flanged ends (Flat Faced), 2 piece body, (<DN250) floating ball, (≥DN250) trunion mounted ball, Full Bore (FB), PTFE seated, anti-static device, blow-out proof stem, gland packing, ISO 5211 mounting table, pressure class 150#.

Technical Features

Design	Generally in accordance with API 6D, ISO 14313, ASME B16.24 Body, bonnet castings from a Marine Class Society Approved Foundry on request
Marking	In accordance with API 6D, ISO 14313
Testing	In accordance with API 6D, API 598
Face to Face	In accordance with ASME B16.10:2000 Table 1 Column 18
Flange Dimensions	In accordance with ASME B16.5-Class 150# (Flat Faced)
Pressure Rating	In accordance with ASME B16.24-Class 150# *
Temperature Range	-29°C to +175°C Note: PTFE seated valves are limited to max. +175°C **
Options	<ul style="list-style-type: none"> - In ASTM B61 bronze (Suffix B61) - In other bronze materials - With other flanged connections DIN, JIS etc. - With other seat, ball and stem materials - With Marine Class Inspection Certificate (EN10204-3.2) by ABS, BV, DNV, LRS and other (Marine Class) Societies

Pressure and Temperature Range [Barg/°C]

DN	Press Class	Mat.	Pressure / Temperature Rating to ASME B16.24* [Barg / °C]													
			29/66	100	125	150	175**	200	208	225	232	250	275	289	°C	
½"-24"	150#	B62	15.5	14.3	13.4	12.4	11.4									Barg
½"-24"	150#	B61	15.5	14.6	14.1	13.4	12.4									Barg

* Above P-T table is extracted from ASME B16.24 materials ASTM B62 and B61, class 150#

** PTFE seated valves are limited to maximum +175°C

Materials

Parts Description	Figure 7235-B62	Figure 7235-B61
Body, Cap, Ball (> DN100)	Cast Bronze ASTM B62	Cast Bronze ASTM B61
Ball (≤ DN100), Stem	Brass ASTM B124-C337700	Brass ASTM B124-C337700
Seat	PTFE	PTFE
Seat Retainer (> DN200)	Cast Bronze ASTM B62	Cast Bronze ASTM B61

Dimensions [mm]

DN	ød	øD	øC	n x øh	L	H	W	
1/2"	DN15	13	90	60.3	4-15.9	108	99	125
3/4"	DN20	19	100	69.8	4-15.9	117	103	125
1"	DN25	25	110	79.4	4-15.9	127	114	155
1 1/2"	DN40	38	125	98.4	4-15.9	165	139	230
2"	DN50	51	150	120.7	4-19.1	178	149	230
2 1/2"	DN65	64	180	139.7	4-19.1	190	155	350
3"	DN80	76	190	152.4	4-19.1	203	170	350
4"	DN100	102	190	190.5	8-19.1	229	190	450
5" *	DN125	127	255	215.9	8-22.2	356	316	ø 400
6" *	DN150	152	280	241.3	8-22.2	394	336	ø 400
8" *	DN200	203	345	298.5	8-22.2	457	420	ø 500
10" *	DN250	254	405	362.0	12-25.4	533	396	ø 500
12" *	DN300	305	485	431.8	12-25.4	610	417	ø 500
14" *	DN350	334	535	476.3	12-28.6	686	458	ø 500
16" *	DN400	385	595	539.8	16-28.6	762	456	ø 710
18" *	DN450	436	635	577.9	16-31.8	864	565	ø 710
20" *	DN500	487	700	635.0	20-31.8	914	620	ø 710
24" *	DN600	589	815	749.3	20-34.9	1067	724	ø 800

* = With Gear Operator

Ball Valves

Flanged

Bronze

Full Bore, Split Body, 300#



Fig. 7236-B62

Full Bore

> DN200 (Trunion mounted Ball)

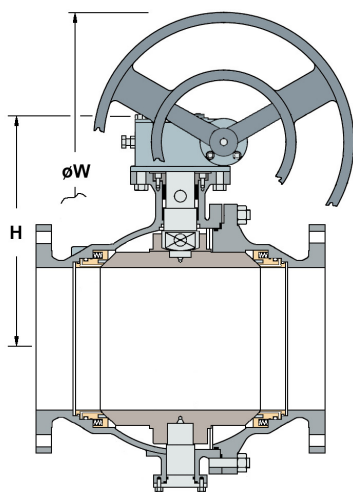

≤ DN200 (Floating Ball)

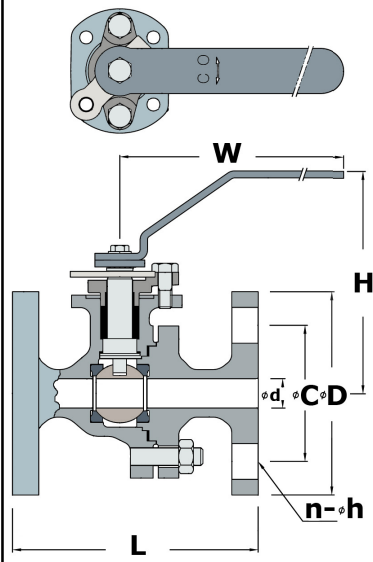

Description

Bronze ball valve, flanged ends (Flat Faced), 2 piece body, (<DN250) floating ball, (≥DN250) trunion mounted ball, Full Bore (FB), PTFE seated, anti-static device, blow-out proof stem, gland packing, ISO 5211 mounting table, pressure class 300#.

Technical Features

Design	Generally in accordance with API 6D, ISO 14313, ASME B16.24 Body, bonnet castings from a Marine Class Society Approved Foundry on request
Marking	In accordance with API 6D, ISO 14313
Testing	In accordance with API 6D, API 598
Face to Face	In accordance with ASME B16.10:2000 Table 2 Column 7
Flange Dimensions	In accordance with ASME B16.5-Class 300# (Flat Faced)
Pressure Rating	In accordance with ASME B16.24-Class 300# *
Temperature Range	-29°C to +175°C Note: PTFE seated valves are limited to max. +175°C **
Options	<ul style="list-style-type: none"> - In ASTM B61 bronze (Suffix B61) - In other bronze materials - With other flanged connections DIN, JIS etc. - With other seat, ball and stem materials - With Marine Class Inspection Certificate (EN10204-3.2) by ABS, BV, DNV, LRS and other (Marine Class) Societies

Pressure and Temperature Range [Barg/°C]

DN	Press Class	Mat.	Pressure / Temperature Rating to ASME B16.24* [Barg / °C]													
			29/66	100	125	150	175**	200	208	225	232	250	275	289	°C	
1/2"-24"	300#	B62	34.5	31.4	29.1	26.8	24.3									Barg
1/2"-24"	300#	B61	34.5	32.4	30.9	29.3	27.6									Barg

* Above P-T table is extracted from ASME B16.24 materials ASTM B62 and B61, class 300#

** PTFE seated valves are limited to maximum +175°C

Materials

Parts Description	Figure 7236-B62	Figure 7236-B61
Body, Cap, Ball (> DN100)	Cast Bronze ASTM B62	Cast Bronze ASTM B61
Ball (≤ DN100), Stem	Brass ASTM B124-C337700	Brass ASTM B124-C337700
Seat	PTFE	PTFE
Seat Retainer (> DN200)	Cast Bronze ASTM B62	Cast Bronze ASTM B61

Dimensions [mm]

DN	ød	øD	øC	n x øh	L	H	W	
1/2"	DN15	13	95	66.7	4-15.9	140	99	200
3/4"	DN20	19	117	82.5	4-19.1	152	103	200
1"	DN25	25	123	88.9	4-19.1	165	114	240
1 1/2"	DN40	38	155	114.0	4-22.2	190	139	350
2"	DN50	51	165	127.0	8-19.1	216	149	350
2 1/2"	DN65	64	190	149.2	8-22.2	241	152	400
3"	DN80	76	210	168.3	8-22.2	282	170	400
4"	DN100	102	255	200.0	8-22.2	305	206	500
5" *	DN125	127	280	234.9	8-22.2	381	358	ø 450
6" *	DN150	152	320	269.9	12-22.2	403	378	ø 450
8" *	DN200	203	380	330.2	12-25.4	502	378	ø 550
10" *	DN250	252	445	387.4	16-28.6	568	420	ø 500
12" *	DN300	303	520	450.8	16-31.8	648	418	ø 500
14" *	DN350	337	585	514.4	20-31.8	762	625	ø 560
16" *	DN400	387	650	571.5	20-34.9	838	670	ø 560
18" *	DN450	438	710	628.6	24-34.9	914	698	ø 630
20" *	DN500	489	775	685.8	24-34.9	991	840	ø 630
24" *	DN600	591	915	812.8	24-41.2	1143	1050	ø 710

* = With Gear Operator



KASKO DEMİRÇELİK MAKİNE VE İNŞAAT SANAYİ TİCARET LİMİTED ŞİRKETİ

**Güzelyurt Mah. Mehmet Akif Ersoy Cad. No: 38 Gökdemir Plaza Kat: 3 Ofis: 24 Zip Code:
34524 Esenyurt / İSTANBUL**

Tel: +90 850 441 25 67

Cell: +90 541 699 01 34

info@kaskomakine.com

kaskomakine.com